

Value600EILCD/Value800EILCD
Value1000EILCD

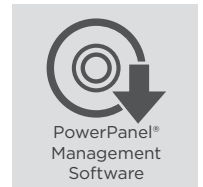

IEC SOCKETS FOR PROFESSIONAL USAGES

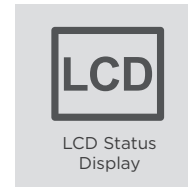
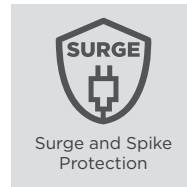
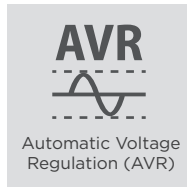
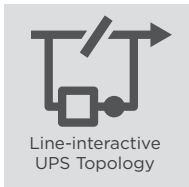

The GreenPower UPS providing reliable power protection with built-in Automatic Voltage Regulation for home and office

Ideal for home, SOHO office, office and back office applications, the Value Series adopts line-interactive topology with Automatic Voltage Regulation (AVR) function to offer stabilized AC power output. This series features IEC sockets for connections with PCs, laptops, and printers, etc. The included RJ11/RJ45 port can provide data line protection against surge and spike. The products' power management software achieves real-time monitoring and configuration.

APPLICATION

- Home
- Office
- SOHO Office
- Back Office

SERIES FEATURES

- Line-interactive UPS Topology
- Automatic Voltage Regulation (AVR)
- Surge and Spike Protection
- LCD Status Display
- Tower Form Factor
- Energy Saving Technology
- Overload Protection
- Phone/Fax/Modem/DSL/Network Protection
- PowerPanel® Management Software

PRODUCT CALLOUTS

1. Power On Indicator
2. Power On/Off Switch
3. LCD Display Panel
4. Function Button(s)
5. Battery Backup & Surge Protected Outlets
6. Communication Protection Ports RJ11/RJ45
7. Input Fuse
8. AC Inlet
9. Serial Port
10. USB Port

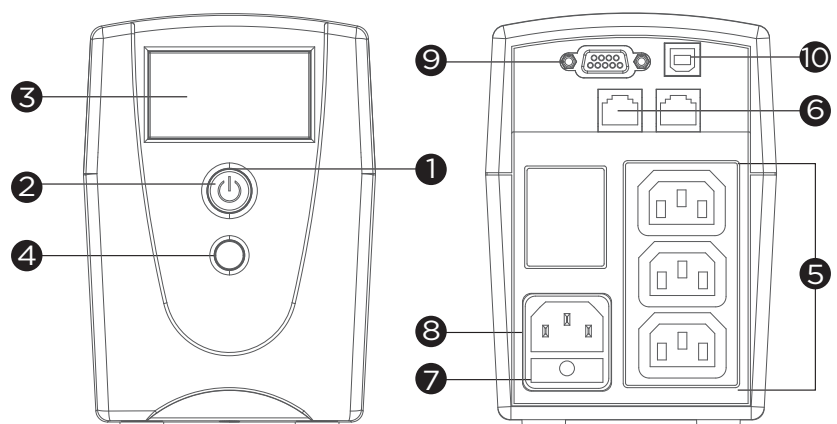

Value600/800/1000EILCD



TECHNICAL SPECIFICATIONS

Model Name	Value600EILCD	Value800EILCD	Value1000EILCD
General			
UPS Topology	Line-interactive	Line-interactive	Line-interactive
Energy Saving Technology	GreenPower UPS™ Bypass Technology	GreenPower UPS™ Bypass Technology	GreenPower UPS™ Bypass Technology
Input			
Nominal Input Voltage (Vac)	230 ± 10%	230 ± 10%	230 ± 10%
Input Voltage Range (Vac)	165 - 280	165 - 280	165 - 280
Input Frequency (Hz)	50 ± 5, 60 ± 5	50 ± 5, 60 ± 5	50 ± 5, 60 ± 5
Input Frequency Detection	Auto-sensing	Auto-sensing	Auto-sensing
Rated Input Current (A)	2.72	3.64	4.55
Input Connector Type	IEC C14	IEC C14	IEC C14
Output			
Capacity (VA)	600	800	1000
Capacity (Watts)	360	480	550
On Battery Waveform	Simulated Sine Wave	Simulated Sine Wave	Simulated Sine Wave
On Battery Voltage(s) (Vac)	230 ± 10%	230 ± 10%	230 ± 10%
On Battery Frequency (Hz)	50 ± 1%, 60 ± 1%	50 ± 1%, 60 ± 1%	50 ± 1%, 60 ± 1%
Automatic Voltage Regulation (AVR)	Single Boost, Single Buck	Single Boost, Single Buck	Single Boost, Single Buck
Overload Protection	Fuse	Fuse	Fuse
Outlet(s) - Total	3	3	3
Outlet Type	IEC C13 x 3	IEC C13 x 3	IEC C13 x 3
Outlet(s) - Battery & Surge Protected	3	3	3
Typical Transfer Time (ms)	4	4	4
Battery			
Runtime at Half Load (min)	8	7	7
Runtime at Full Load (min)	1	1	1
Typical Recharge Time (Hours)	8	8	8
User Replaceable	No	No	No
Battery Type	Sealed Lead-acid	Sealed Lead-acid	Sealed Lead-acid
Surge Protection & Filtering			
Surge Suppression (Joules)	125	125	125
EMI/RFI Filtration	Yes	Yes	Yes
Phone/Network Protection RJ11/RJ45 (Combo)	1-in, 1-out	1-in, 1-out	1-in, 1-out
Management & Communications			
LCD Panel	Yes	Yes	Yes
HID Compliant USB Port(s)	1	1	1
Serial Port	RS232	RS232	RS232
Audible Alarms	Battery Mode, Low Battery, Overload, Overcharge, UPS Fault		
Power Management Software	PowerPanel® Personal Edition	PowerPanel® Personal Edition	PowerPanel® Personal Edition
Physical			
Form Factor	Tower	Tower	Tower
Physical Size - UPS Module			
Dimensions (WxHxD) (mm.)	100 x 140 x 300	100 x 140 x 300	100 x 140 x 300
Weight (kg.)	4.6	5.2	5.5
Environmental			
Operating Temperature (°C)	0 - 40	0 - 40	0 - 40
Operating Relative Humidity (Non-condensing) (%)	0 - 90	0 - 90	0 - 90
Online Thermal Dissipation (BTU/hr)	99	102	109
Certifications			
Certifications*	CE, EAC	CE, EAC	CE, EAC
RoHS	Yes	Yes	Yes

*Certifications may vary according to different regions. Visit www.cyberpower.com for more information.
#All specifications are subject to change without notice.